



ALOE VERA COURT

An exclusive development in the heart of Maryland, Lagos.





A L O E V E R A C O U R T | M A R Y L A N D | L A G O S

ALOE VERA COURT

QUALITY & CONVENIENCE

Aloe Vera Court is a residential development with terrace houses and maisonnettes situated around a main parking area creating a courtyard effect and thus ensuring clean views and fresh air into each home.

Situated in a most serene and exclusive area of Lagos Mainland and with excellent accessibility to Ikeja and Lagos Island via the third main land bridge and Ikorodu road including the Local and International airports.

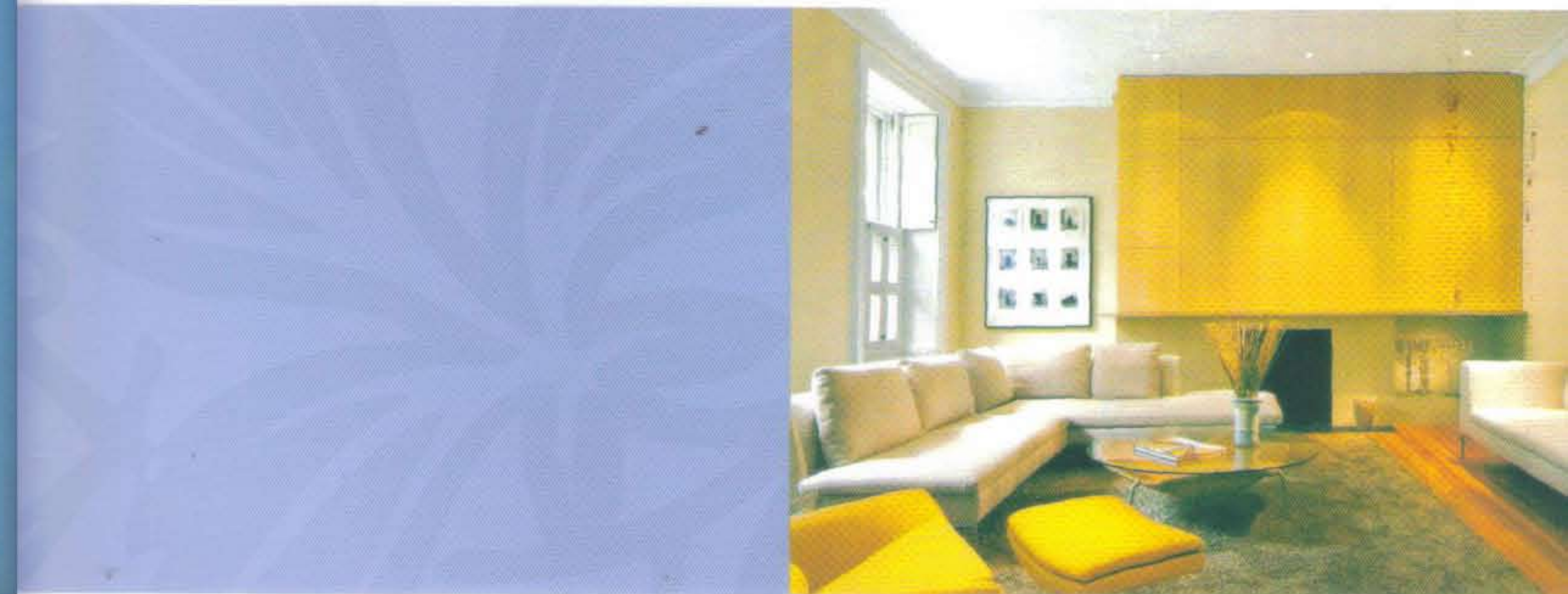

All twelve apartments at this stunning development are bright and airy and are finished to a high standard. All rooms have bathrooms en-suite and are stylishly finished to a high level of detail with classic white sanitary wares.

Attention to detail is paramount.

ALOE VERA COURT

FEATURES

- Fully Serviced apartments
- Dedicated transformer and borehole
- Gated community
- Secure and very private
- Ample parking spaces
- Green areas & landscaped environs
- Swimming pool
- Private Gymnasium



GROUND FLOOR

TERRACE	6.4	1.9 x 3.4
LOBBY	2.0	1.8 x 1.8
LIVING ROOM	14.0	3.8 x 3.8
DINING ROOM	13.0	2.6 x 3.8
KITCHEN	11.0	3.0 x 3.8
STORE	2.0	1.0 x 2.0
MAID	4.6	2.0 x 2.3
MAID BATH	3.0	1.3 x 2.0

PLANS : MAISONNETTE UNIT

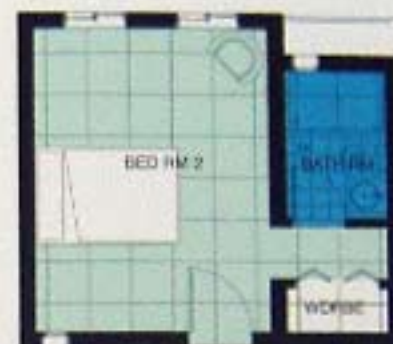

FIRST FLOOR

BEDROOM 1	16.0	3.4 x 3.8
BEDROOM BATH	3.0	1.5 x 2.1
BEDROOM 2	16.0	3.4 x 4.4
BEDROOM 2 BATH	3.0	1.5 x 2.1
LOUNGE	13.0	2.6 x 3.8



SECOND FLOOR

MASTER BEDROOM	19.0	3.8 x 5.1
MASTER BATH	6.0	1.6 x 3.8
STUDY	10.0	2.9 x 3.8
DRESSER	6.0	2.5 x 3.4
TERRACE	6.4	1.9 x 3.4

ALOE VERA COURT

FEATURES

- Out door sitting areas
- En suite facilities in all apartments
- Maids quarters
- Telephone and satellite TV points



PLANS : TERRACE UNIT



Ground Floor

Terrace	9.6	2.4 x 4.0
Lobby	2.4	1.5 x 1.5
Living Room	24	3.7 x 6.0
Master Toilet	2.0	1.5 x 2.0
Living Room	14.2	3.5 x 4.4
Kitchen	14	3.4 x 4.0
Utility	3.0	1.4 x 2.1
Bed Room	3.2	1.9 x 2.2
Bed Bath	3.1	1.9 x 1.65

First Floor

Family Room	20	3.5 x 4.4
Master Bedroom	18	3.7 x 5.1
Master Bath	7.2	1.9 x 3.8
Bedroom 1	13	3.4 x 3.5
Bedroom Bath	3	1.6 x 2.3
Bedroom 2	13	3.4 x 3.5
Bedroom Bath	3	1.6 x 2.3
Terrace	5.6	1.1 x 5.0

ALOE VERA COURT

LOCATION
LOCATION
LOCATION

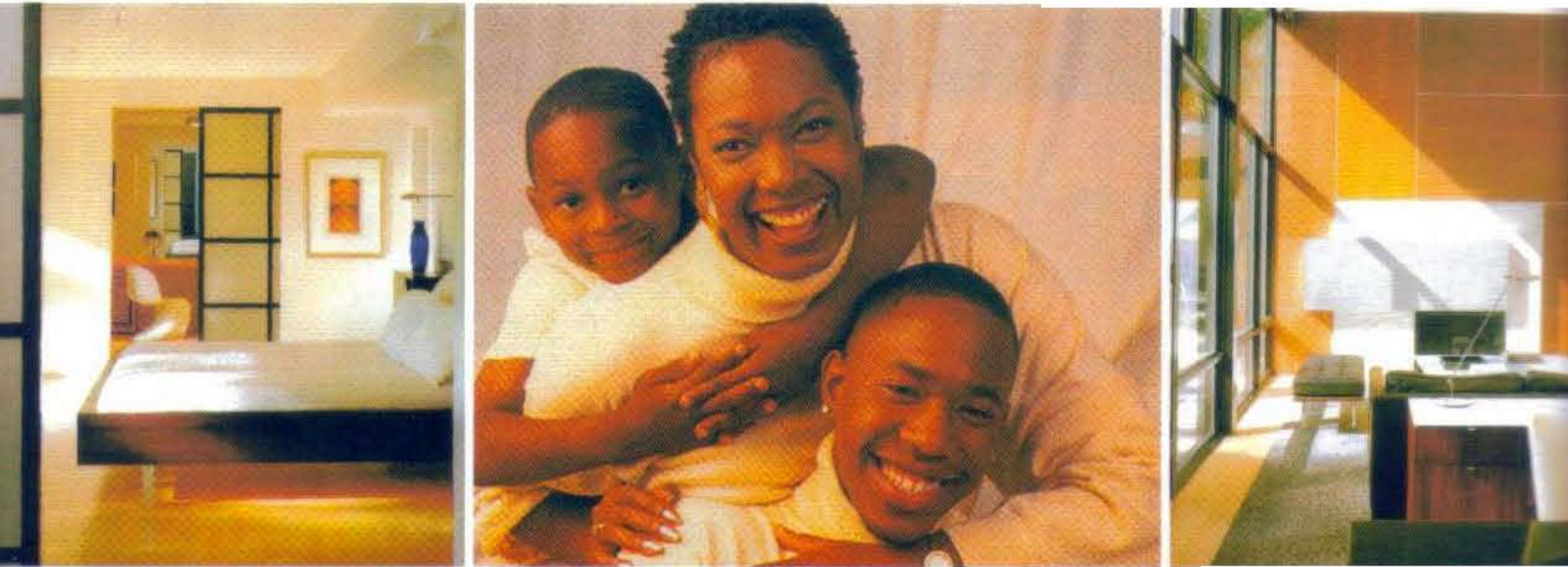

ALOE VERA COURT | MARYLAND | LAGOS



As with all Briscoe Properties Developments, we have chosen a location that is hard to beat. Aloe Vera Court offers excellent accessibility to Ikeja, Lagos Island via Third Mainland Bridge and to the Express way out of Lagos.



ALOE VERA COURT

CONTACT INFORMATION

Seni 0803 321 0413

Titi 0802 340 9767

Tolu 01 791 6122

BRISDALE PROPERTY DEVELOPMENT COMPANY A SUBSIDIARY OF



18, FATAI ATERE WAY, MATORI, LAGOS.
NIGERIA.